

INSTALLATION INSTRUCTIONS

KITCHEN FAUCET 廚房龍頭安裝說明

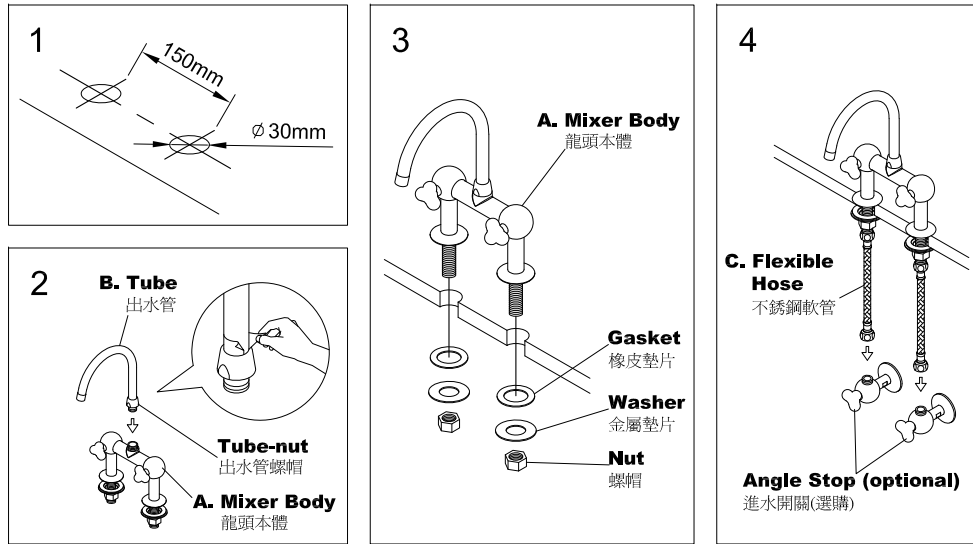

1. Drill 2 holes on appropriate position as Fig.1 shown.
在適當的位置鑽2個孔，如 Fig.1 所示。
2. Tear the protect membrane, then Insert **Tube** into **Mixer body** and tighten the **tube-nut** as Fig.2 shown.
撕去保護膜，然後將出水管置入龍頭本體，並且將出水管螺帽鎖緊固定住。如 Fig.2 所示。
3. Install the Mixer as Fig.3 shown.
如 Fig.3 所示。安裝水龍頭。
4. Connect **Flexible Hoses** from **Mixer** to **Angle Stops** as Fig.4 shown.
連接不銹鋼軟管從本體到進水開關。如 Fig.4 所示。

FIXING CONTENTS

組配件內容

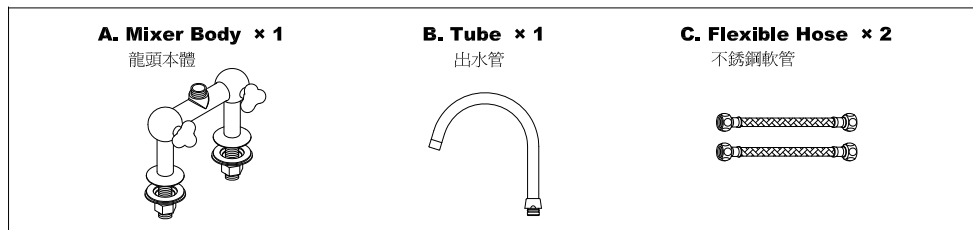

INSTALLATION INSTRUCTIONS

KITCHEN FAUCET 廚房龍頭安裝說明

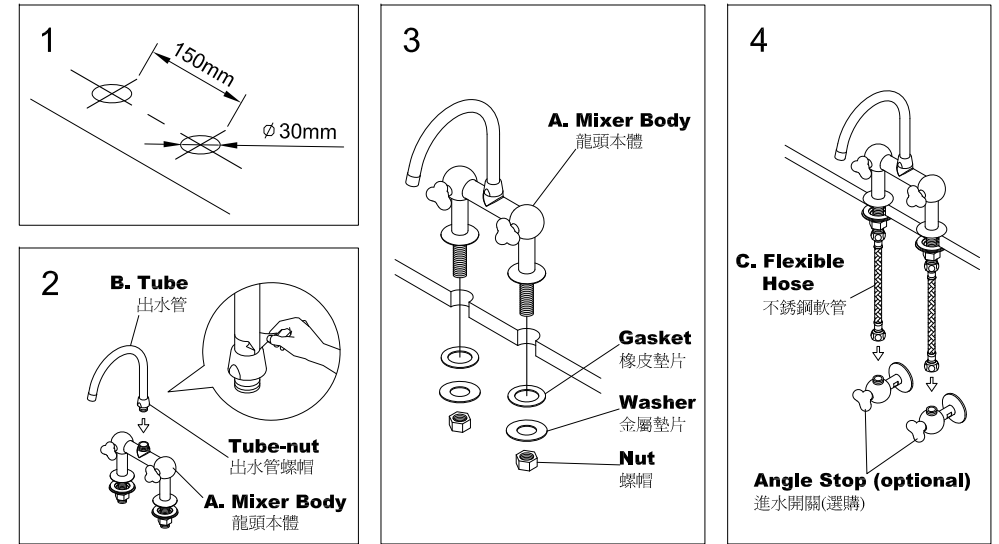

1. Drill 2 holes on appropriate position as Fig.1 shown.
在適當的位置鑽2個孔，如 Fig.1 所示。
2. Tear the protect membrane, then Insert **Tube** into **Mixer body** and tighten the **tube-nut** as Fig.2 shown.
撕去保護膜，然後將出水管置入龍頭本體，並且將出水管螺帽鎖緊固定住。如 Fig.2 所示。
3. Install the Mixer as Fig.3 shown.
如 Fig.3 所示。安裝水龍頭。
4. Connect **Flexible Hoses** from **Mixer** to **Angle Stops** as Fig.4 shown.
連接不銹鋼軟管從本體到進水開關。如 Fig.4 所示。

FIXING CONTENTS

組配件內容

