

Concealed Mixer Valve W/Diverter
6927-XY-80CP

INTRODUCTION:

Designer observed kinds of organisms to sketch contours of product for expounding orderless growth and concept of meristem. Mixer has been combined with stylish handles and organic spout just like to personally experience the pulsation of life. Movable cartridge structure is not only a good solution, but also additional value of products for consumers.



DESCRIPTION:

1. Material of brass handle meets JIS 3771 standard.
2. Material of stainless steel faceplate meets SUS 304 standard.
3. Finish meets the standard of ASTM-SC2.
4. The faucet should be used at the water pressure from 1 to 4 kg/cm².
5. Using the C-ring provided if the water pressure is under 1kgf/cm²/(14.2PSI).
6. G1/2 inlet.
7. Adjust the water supply by pressing diverter.
8. The inlet of both sides are assembled the check valves for avoiding the backflow of cold and hot water.
9. Coordinates with other products in Nature collection.

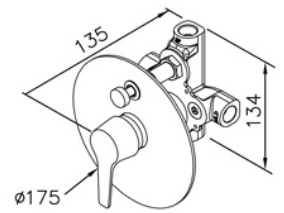

unit:mm

Certification:

Fixing Kits:

1. SUS 304 Stainless Steel Screws*1.
- Hex Key 2.0mm*1.
- Hex Key 2.5mm*1.
- Set Screw*1.
- Key Tool*1.

AWARD: